

Seetal Spray Booth – Tingalpa, Queensland

The Seetal Spray Booth is a combination spray painting booth with low temperature baking oven. Installed in Tingalpa in September 2015, the Spray Booth is full downdraft with a filter floor and fully complying with AS/NZS 4114.

| | |
|--------------------------|------------------------------|
| MANUFACTURER | Seetal Spray Booth Pty. Ltd. |
| MANUFACTURED DATE | 15/09/2015 |
| MODEL NUMBER | Seetal Full Down Draught |
| TEMPERATURE SPRAY | 25deg Celsius. |
| TEMPERATURE BAKE | 80deg Celsius . |
| TYPE OF GAS | LPG |
| TYPE OF BURNER | Direct Fired |
| TYPE OF GAS TRAIN | Double Block |



Expressions Of Interest In Writing Before Close Of Business Friday 9 February At 4.00pm

Inspection By Appointment Only, Please Contact Ian Wakeley on 0412 113 568 | 03 9687 4955

Email: auction@dominiongroup.net.au Website: www.dominiongroup.net.au

Seetal Spray Booth

Approximate dimensions of the spray booth:

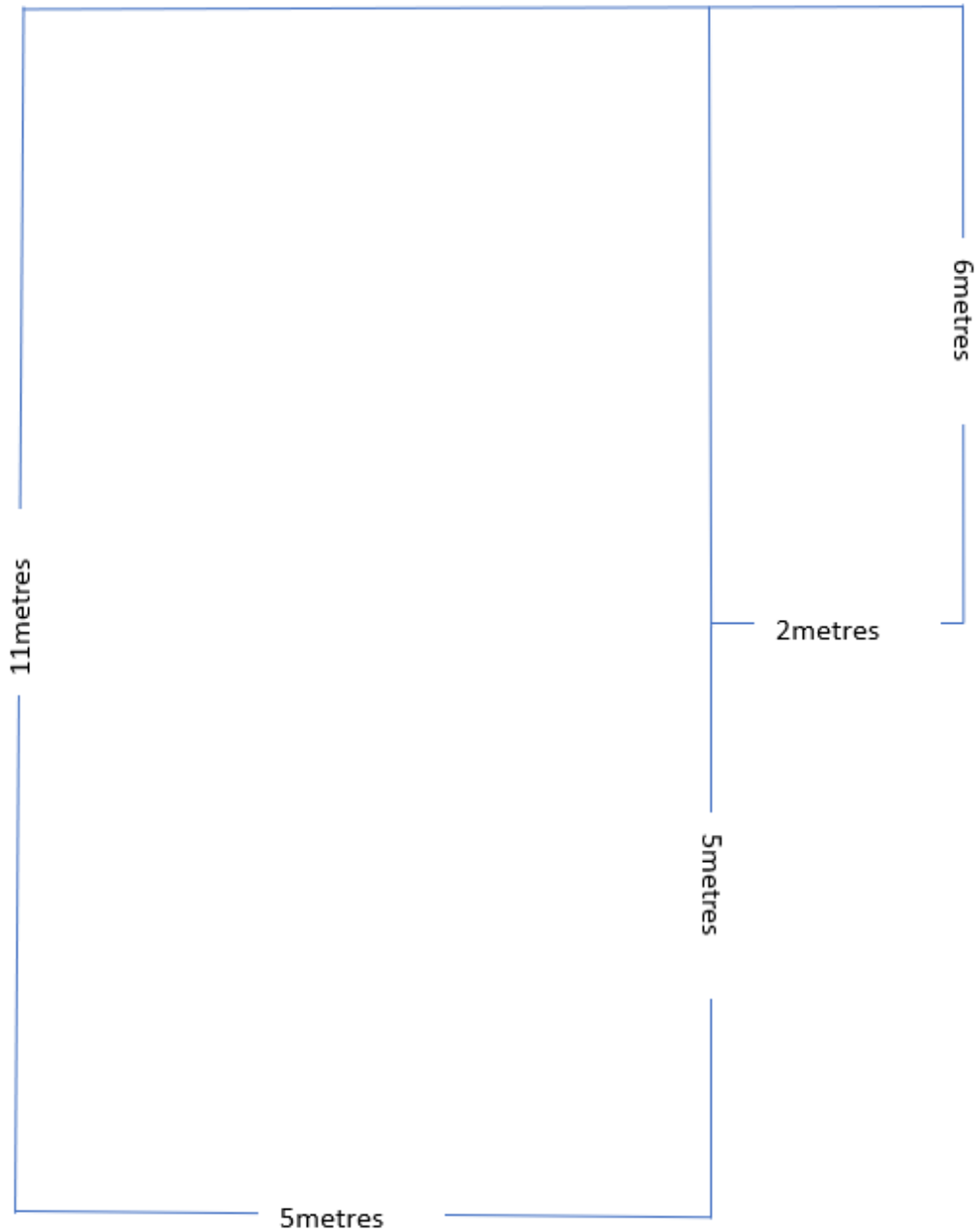

Height of booth is 3.5metres plus 1metre for handrails and ducting.

Expressions Of Interest In Writing Before Close Of Business Friday 9 February At 4.00pm

Inspection By Appointment Only, Please Contact Ian Wakeley on 0412 113 568 | 03 9687 4955

Email: auction@dominiongroup.net.au Website: www.dominiongroup.net.au